

**NEW EMPLOYEE ORIENTATION**

**LOCATION & PARKING**

New Employee Orientation is held at Evanston Hospital, in the Frank Auditorium, 2650 Ridge Ave, Evanston, IL.

Please park in the Graham Medical Office Building parking structure located at 1000 Central Street (directly south of the hospital). The entrance to the parking garage is on Central Street just west of the intersection of Central & Ridge. You will receive a parking validation for this parking garage.

**From the 1000 Central Street parking structure** – Take the elevator to level “P3”. Follow the corridor across Central Street, into the hospital & through the atrium. Take the escalator down one level. Follow the corridor to the right and the auditorium is located down the hall on the right.

**From Evanston Hospital main lobby** - Take the escalator up one floor to level “1” (the lobby is on level “G”), veer right and follow the corridor until you arrive at the auditorium, which will be on your right.

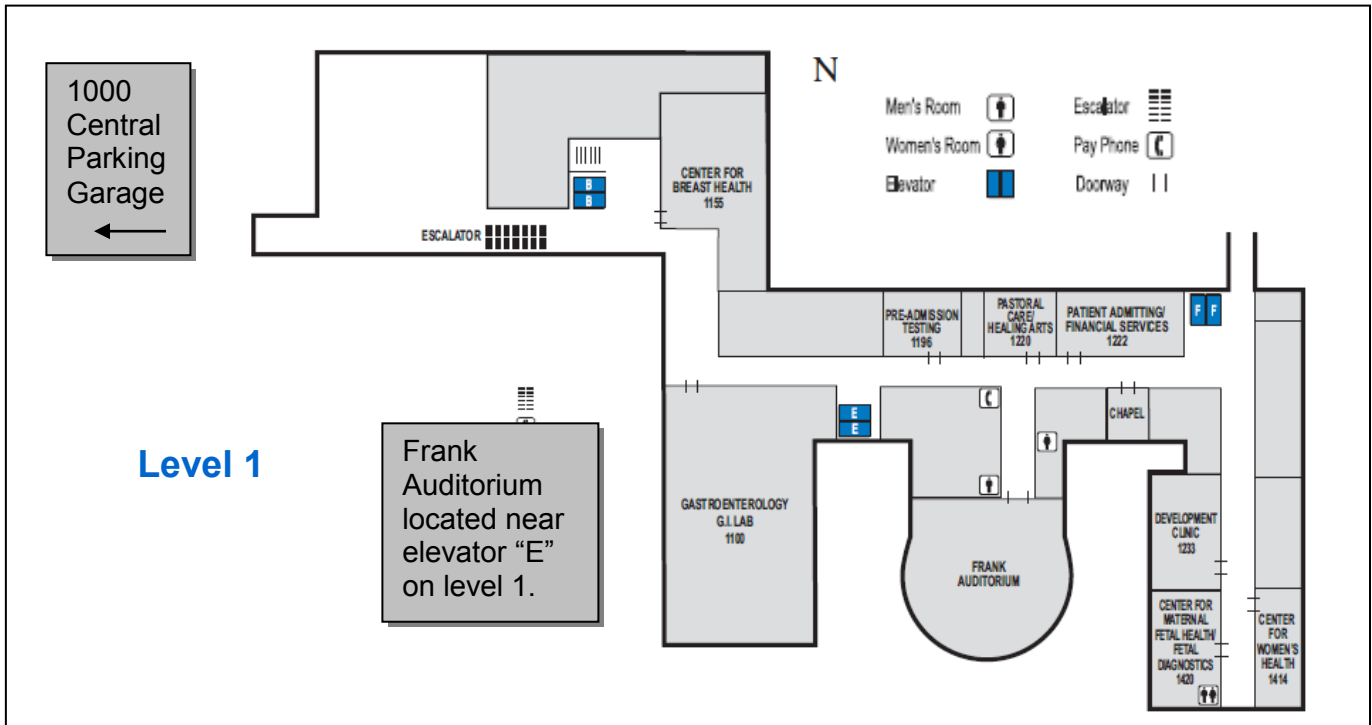

**PUBLIC TRANSPORTATION**

For more specific directions, go to [www.transitchicago.com](http://www.transitchicago.com) to plan your trip or call (888) 968-7282.

- Via CTA: Take the Purple line to Central Street. The hospital is located directly across the street.
- Via Metra: Take the Union Pacific North line, exit at Central Street. From there, take the CTA bus #201 to Central & Girard (adjacent to the El stop) or walk east for about 10 blocks to the hospital.