

# Evanston Hospital Map

## General Information | Kellogg Cancer Center

### Evanston Hospital

### Ground Floor

2650 Ridge Avenue  
Evanston, IL 60201

(847) 570-2000

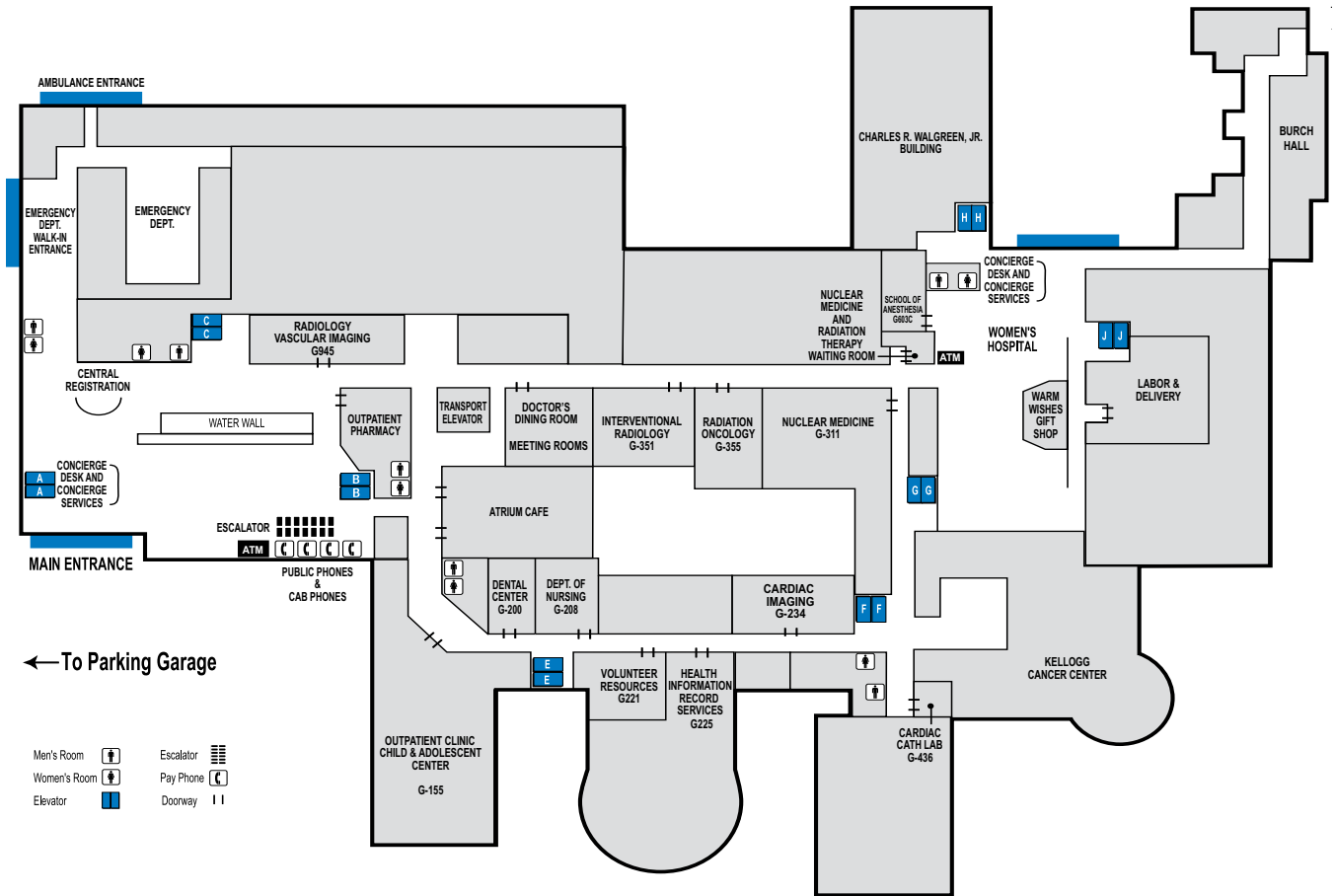

Elev.	Floor	Patient Care Units
B	1R	Fetal Diagnostics/ Colposcopy
	1R	Gastroenterology/ GI Lab
	3	Ambulatory Surgery
	4	ICU
	4	4 South Searle
	5	5 North Searle
	5	5 South Searle
	5	Infusion Center Observation Unit
C	4	4 South Searle
	5	5 North Searle
	5	5 South Searle
E	2 South	Rehabilitation
	3 Center	Hemodialysis

Elev.	Floor	Patient Care Units
F	2 North	CCU
	3 Center	Hemodialysis
	3 North	Pediatrics
	4 East Louis	Med/Surg Unit
	4 North	IV Therapy
	6	Cardiopulmonary Rehabilitation
G	4 North	Neurophysiology (EEG Lab)
J	1	Breastfeeding Resource Center
	1	Infant Special Care Unit
	2	Women's Hospital
	3	Women's Hospital

# Evanston Hospital Map

## General Information | Kellogg Cancer Center

### Evanston Hospital

2650 Ridge Avenue  
Evanston, IL 60201  
(847) 570-2000

### First Floor

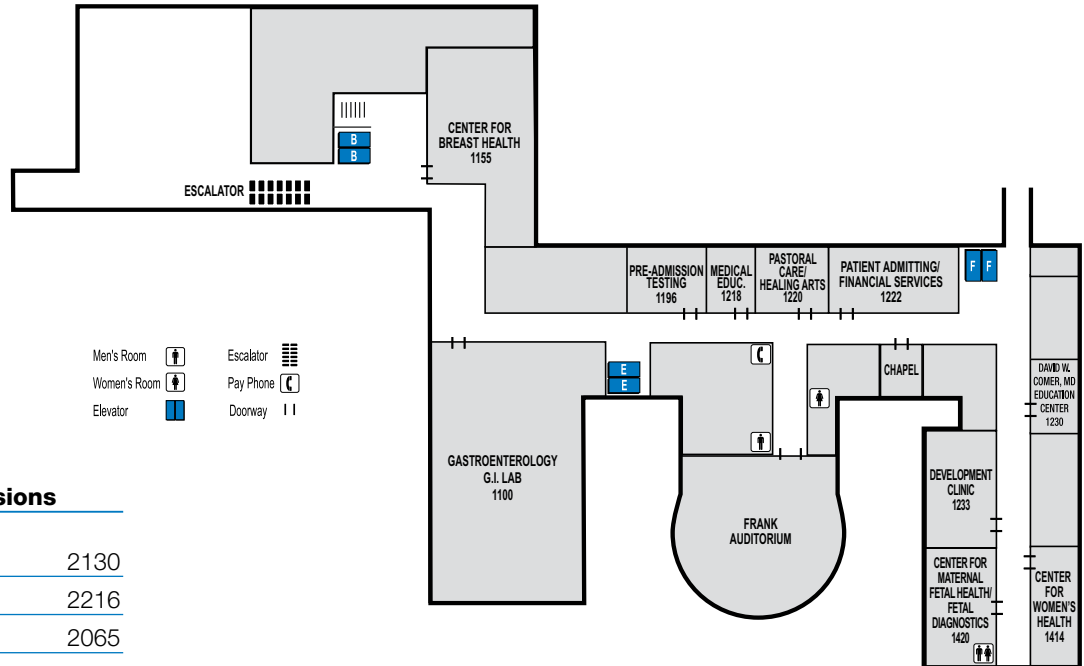

#### Phone Number Extensions

Admitting/Financial Services	2130
Cardiac Cath	2216
Cardiac Graphics	2065
Center for Maternal Fetal Health/Fetal Diagnostics	2860
Concierge Services	
Internal: Dial	4-YOU (4968)
External: Dial	(224) 364-4-YOU or (224) 364-4968
Dental Center	2380
EEG/Sleep Center	2575
Emergency Dept.	2111
Gastroenterology/GI Lab	2236
Kellogg Cancer Center	2112
Labor & Delivery	2222
Nuclear Medicine	2591
Observation Unit	2844
Outpatient Pharmacy	2210
Outpatient Clinic/CAC	2700
Outpatient Lab	3903
Pastoral Care/Healing Arts	2330
Pre-Admission Testing Service	4710
Radiology	2528
Well Wishes Gift Shop	2717

### Mezzanine

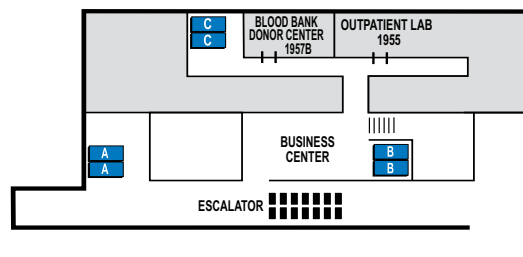

# Glenbrook Hospital Map

## Glenbrook Hospital

2100 Pfingsten Road  
Glenview, IL 60026  
(847) 657-5800

## General Information | Kellogg Cancer Center

### First Floor

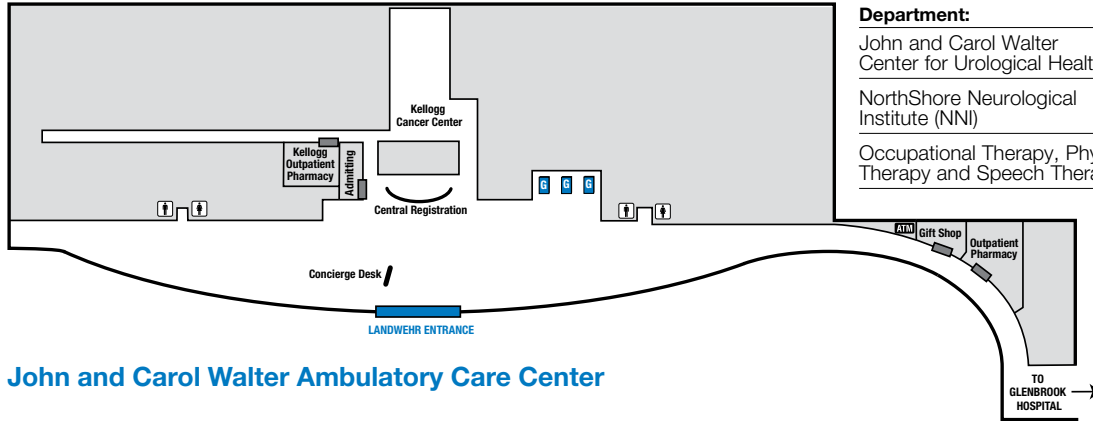

Department:	Use Elevator:	To Floor:
John and Carol Walter Center for Urological Health	G	3
NorthShore Neurological Institute (NNI)	G	2
Occupational Therapy, Physical Therapy and Speech Therapy	G	LL

### John and Carol Walter Ambulatory Care Center

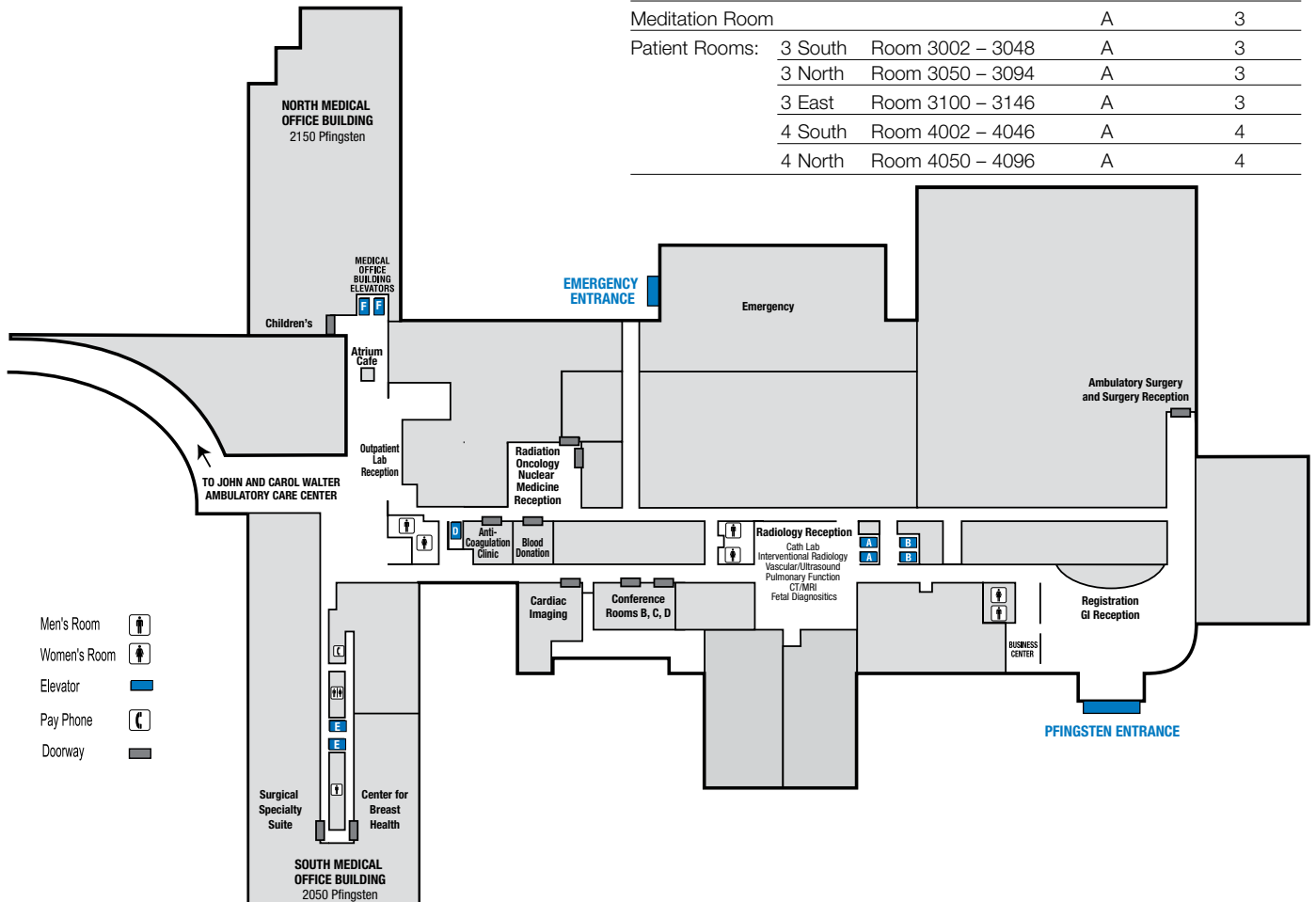

Department:	Use Elevator:	To Floor:
Conference Room A1, A2	B	2
ICU Room 1 - 17	A	4
Meditation Room	A	3
Patient Rooms: 3 South Room 3002 - 3048	A	3
3 North Room 3050 - 3094	A	3
3 East Room 3100 - 3146	A	3
4 South Room 4002 - 4046	A	4
4 North Room 4050 - 4096	A	4

- Men's Room
- Women's Room
- Elevator
- Play Phone
- Doorway

# Highland Park Hospital Map

General Information | Kellogg Cancer Center

## Highland Park Hospital

## First Floor

777 Park Avenue West  
Highland Park, IL 60035  
(847) 432-8000

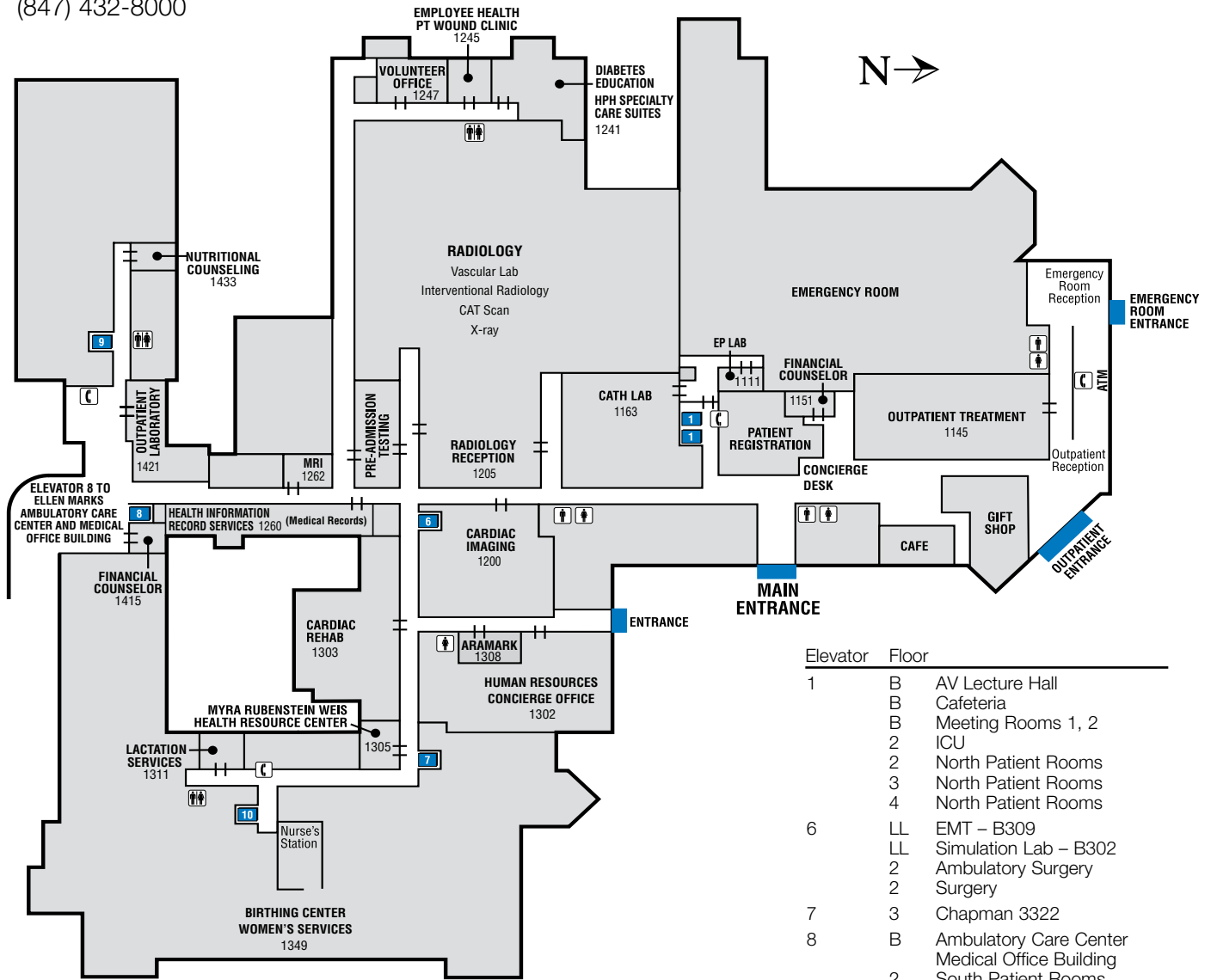

Elevator	Floor	Room/Service
1	B	AV Lecture Hall
	B	Cafeteria
	B	Meeting Rooms 1, 2
	B	ICU
2	2	North Patient Rooms
	2	North Patient Rooms
3	3	North Patient Rooms
	3	North Patient Rooms
6	LL	EMT - B309
	LL	Simulation Lab - B302
	2	Ambulatory Surgery
	2	Surgery
7	3	Chapman 3322
8	B	Ambulatory Care Center
	B	Medical Office Building
	B	South Patient Rooms
9	2	Dialysis
	3	Dialysis
10	2	Patient Rooms
	3	EDU
	LL	Meeting Rooms 3, 4
	ML	EEG - 326
	ML	EMG - 326
ML	ML	Outpatient Physical and Occupational Therapy - B400
	ML	GI Lab

- Men's Room
- Women's Room
- Elevator
- Pay Phone
- Doorway